

HEAVY DUTY SCISSOR LIFT

- A range of maximum lift heights from 1050 to 2900mm
- Manual or battery electric operation
- Robust construction
- Easy to manoeuvre
- Unique lift up lid to allow safe and easy maintenance
- Quality European manufacture and design



TECHNICAL FEATURES

ALL MODELS

- Single double or triple lifts available
- Heavy duty arm, bearings and hydraulics
- Nylon bushes fitted at all arm end hinge points
- Heavy duty castor wheels one of which is fitted with a total stop brake as standard- prevents table from moving when loading and unloading
- All models fitted with an overload valve and slow lowering valve to control lowering speed
- The base frame is designed to give low closed height and maximum stability
- Each table is issued with operating instructions and a test certificate

BATTERY ELECTRIC MODELS

- Models include 12v traction battery and charger
- Safety cut-off bar fitted to the underside of the platform stops table from lowering in the case of an obstruction
- Remote push button control up/down operation
- Emergency stop switch
- Safe design plug-in charger
- Strong electrical flex

TECHNICAL SPECIFICATION

SINGLE SCISSOR TABLES

Capacity	C Raised Height	B Closed Height	Operation	E x A Platform W x L	E x D O/A W x L	F Handle Height	Wheel Dia	Approx Weight	Stock Code
800KG	1050	360	Manual Hyd	840 X 1350	860 X 1650	1010	150/200	222	MSC800SM
800KG	1050	360	Battery Electric	840 X 1350	860 X 1650	1010	150/200	270	MSC800SE
1250KG	1050	360	Manual Hyd	840 X 1350	860 X 1650	1010	150/200	230	MSC1250SM
1250KG	1050	360	Battery Electric	840 X 1350	860 X 1650	1010	150/200	278	MSC1250SE
1000KG	1050	360	Manual Hyd	1000 X 2000	1000 X 2350	1010	150/200	350	MSC1000SM
1000KG	1050	360	Battery Electric	1000 X 2000	1000 X 2350	1010	150/200	397	MSC1000SE

DOUBLE SCISSOR TABLES

Capacity	C Raised Height	B Closed Height	Operation	E x A Platform W x L	E x D O/A W x L	F Handle Height	Wheel Dia	Approx Weight	Stock Code
500KG	1900	490	Manual Hyd	840 X 1350	860 X 1650	1010	150/200	306	MSC500DM
500KG	1900	490	Battery Electric	840 X 1350	860 X 1650	1010	150/200	352	MSC500DE
800KG	1900	490	Manual Hyd	840 X 1350	860 X 1650	1010	150/200	315	MSC800DM
800KG	1900	490	Battery Electric	840 X 1350	860 X 1650	1010	150/200	363	MSC800DE

TRIPLE SCISSOR TABLES

Capacity	C Raised Height	B Closed Height	Operation	E x A Platform W x L	E x D O/A W x L	F Handle Height	Wheel Dia	Approx Weight	Stock Code
500KG	2900	650	Manual Hyd	840 X 1350	860 X 1690	1010	150/200	375	MSC500TM
500KG	2900	650	Battery Electric	840 X 1350	860 X 1690	1010	150/200	420	MSC500TE

Options

- Second brake wheel
- Stainless steel top cover
- Plastic roller conveyor top, Increases closed / raised height by 60mm
- Ball Top
- Bellows safety skirt

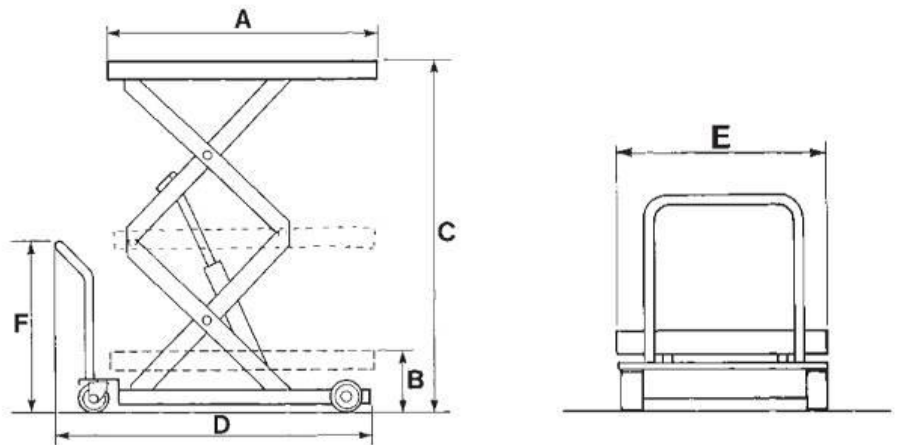

All dimensions are in mm unless otherwise shown