

UNIVERSAL LIFTING CLAMP FEATURES AND SPECIFICATIONS

Applications

Lifting and revolving without marring of smooth or polished pieces such as stainless steel plates, aluminium, pre-lacquered plates, wood, laminated sheets, marble, concrete, glass, plastic ...

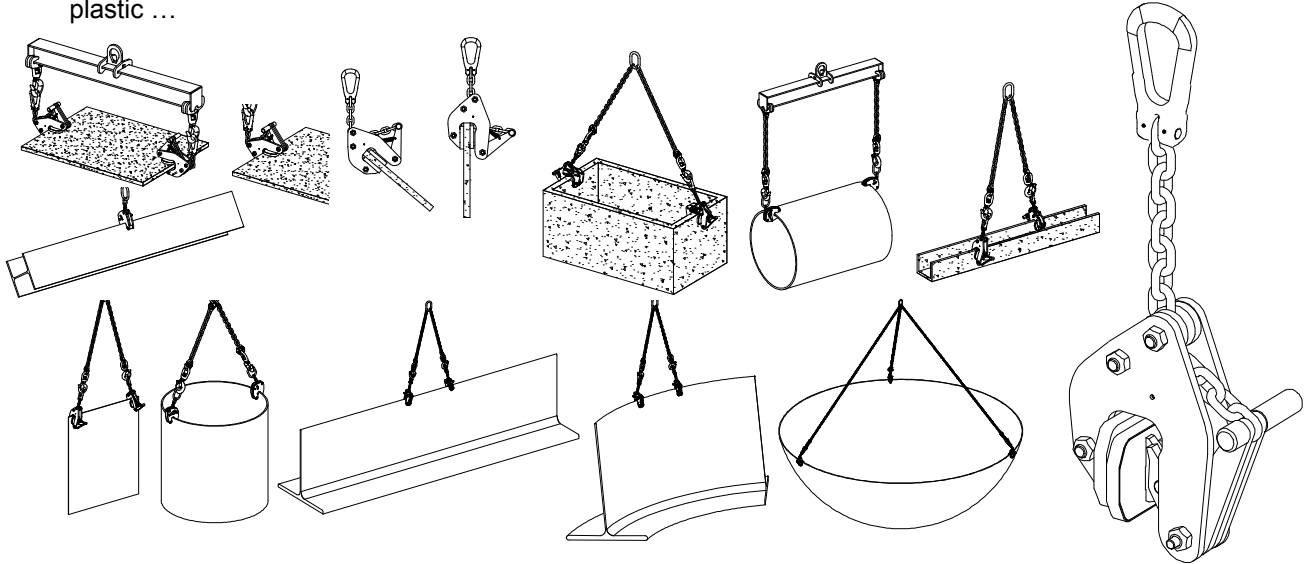

Description

Clamps fitted with jaws coated with polyurethane enabling to lift and revolve loads without marring their surface. These products are equipped with a safety spring mechanism and an automatic grasping which respectively permits a permanent contact of the cam onto the piece to be lifted, even when it is being put down and ensures the clamp's closing when the plate is correctly positioned ie at the back of the clamp's throat. The chain enables the turning and makes the clamp's positioning easier.

Functioning

To open the clamp's jaws, push the handle downwards until the trigger activates ; the handle remains in a down position. When the load is driven home at the back of the clamp's throat, the trigger activates and the clamp locks itself automatically. Lifting ensures proportional clamping, thus avoiding any damage risk.

To release the clamp, push down the handle completely ; the clamp is thus locked in the open position. Loads may be grasped horizontally or vertically and revolved in inverse position (90° or 180°).

Adjustable model: adjust the clamp's opening before use. The adjusting increment is 20 mm.

Fragile pieces: use the manual opening and locking thanks to the handle without bringing it to its limit stop (trigger not activated).

Important instructions

- This clamp can also be used for usual steels.
- The plate or piece to be lifted must always be driven home into the throat of the clamp.
- No limit regarding surface hardness of loads to be lifted.
- Never use on greasy or oily pieces.
- Do not use the automatic grasping mechanism on fragile loads.
- For safety's sake, ensure the clamps are always unlocked when not in use (closed jaws).
- The minimum weight of lifting load should be equal to 5% of the clamp's WLL (eg if clamps WLL is 1000 kg, then minimum weight is 50 kg). This value is given for a clamp in perfect working order and respecting conditions of use and recommendations.
- Lifting clamps are not suitable for creating permanent joints.
- Never lift more than one plate at a time.
- Apply the downgradation if necessary.
- Working temperature: -20° to +80°C.

Subjected to technical modification without notice - Non contractual document.

- *Lifting function:* do not exceed the allowable 15° angle between the chain and the clamp's flanges.

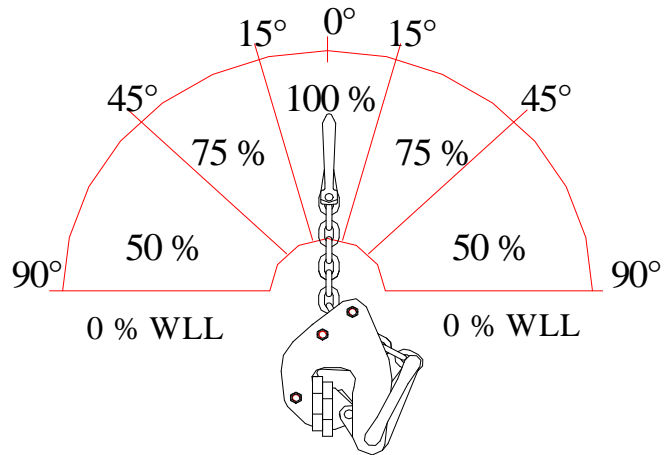
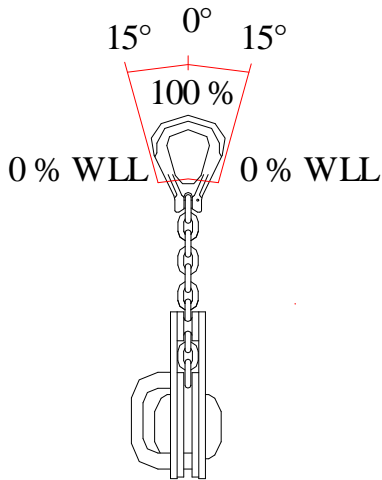

- *Turning function:* for this application, the clamp's working load limit is divided by 2.

- *Function lifting of loads in a vertical position with 2 clamps and no lifting beam:* do not exceed the 30° sling angle.

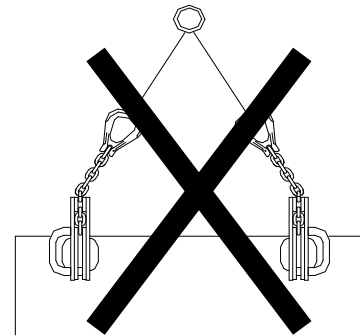
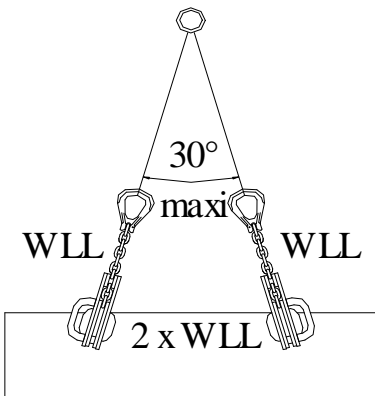

- *Function lifting of loads in a horizontal position using 2 clamps at least and a lifting beam:* the working load limit of each clamp is divided by 2.

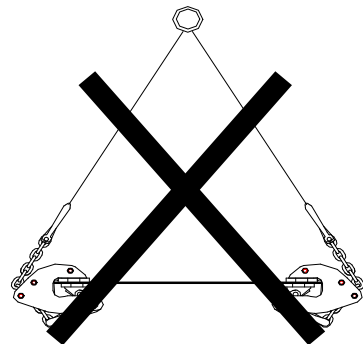
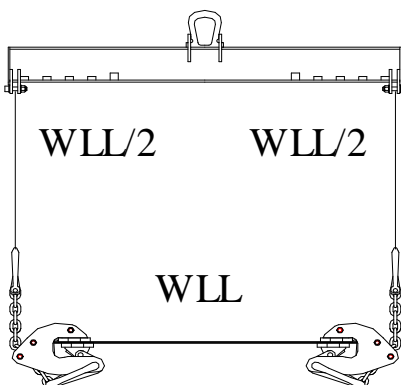

General characteristics

- Manufactured without load bearing welds.
- Hot epoxy coating.
- Safety factor: 3.
- Product with EC marking and delivered with a declaration of conformity and instructions for use.
- Every clamp is tested twice the working load limit.
- 1 year warranty against any defect of fabrication.

Dimensional characteristics

| Ref. | Group code | WLL kg | Opening | | A | | B | C | D | E | F | | G | H | I | J | K | L | M | O | P | Chain Ø | Weight kg |
|---------------|------------|--------|---------|-----|-----|-----|-----|-----|----|-----|-----|-----|----|----|----|----|----|-----|----|----|-----|---------|-----------|
| | | | min | max | min | max | | | | | min | max | | | | | | | | | | | |
| LNx05 0-20 | 50408 | 500 | 0 | 20 | 171 | 221 | 208 | 82 | 50 | 105 | 376 | 460 | 42 | 71 | 41 | 13 | 11 | 80 | 70 | X | 118 | 7 | 4.5 |
| LNxR05 0-100 | 50428 | 500 | 0 | 100 | 178 | 308 | 208 | 82 | 58 | 105 | 379 | 466 | 58 | 71 | 41 | 13 | 11 | 80 | 70 | 20 | 118 | 7 | 6 |
| LNxR05 20-120 | 50438 | 500 | 20 | 120 | 203 | 327 | 208 | 82 | 58 | 105 | 380 | 446 | 58 | 71 | 41 | 13 | 11 | 80 | 70 | 20 | 118 | 7 | 5.78 |
| KNxR05 40-140 | 50448 | 500 | 40 | 140 | 223 | 348 | 208 | 82 | 58 | 105 | 382 | 459 | 58 | 71 | 41 | 13 | 11 | 80 | 70 | 20 | 118 | 7 | 6 |
| LNx1.5 0-30 | 50418 | 1 500 | 0 | 30 | 220 | 285 | 256 | 104 | 68 | 120 | 508 | 610 | 56 | 87 | 49 | 13 | 16 | 100 | 90 | X | 145 | 10 | 11 |

Dimensions in mm

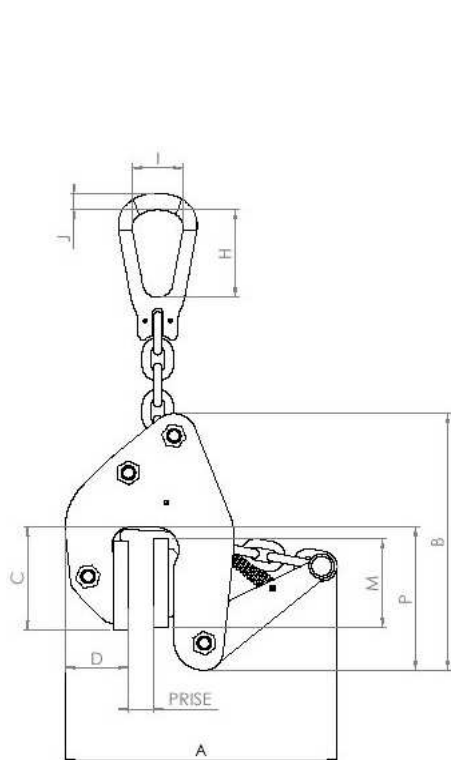

NX

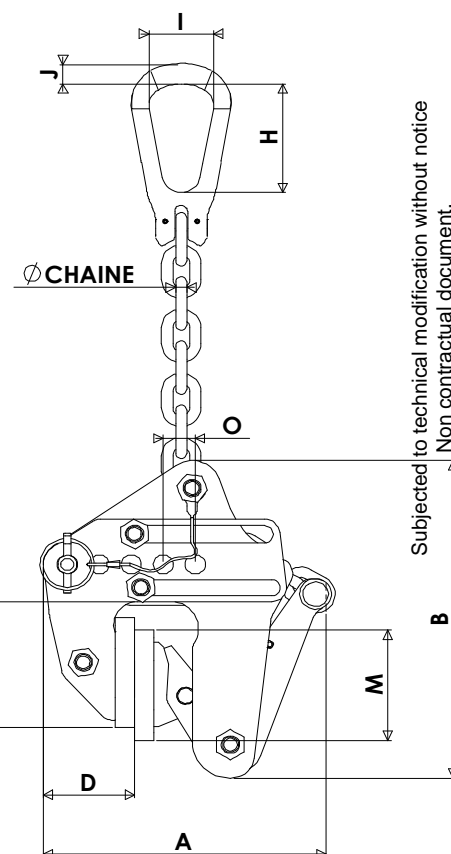
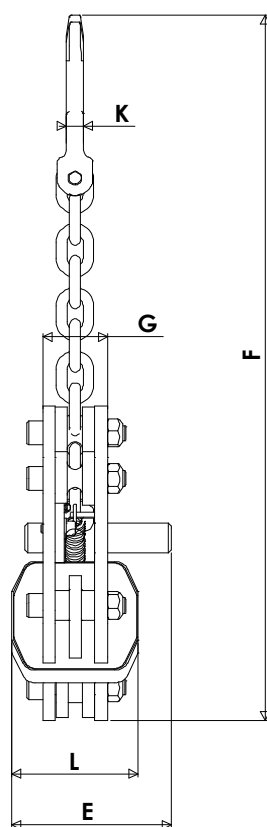

NXR

Subjected to technical modification without notice
Non contractual document.