

SPREADER BEAM MCFM2439 SPECIFICATIONS

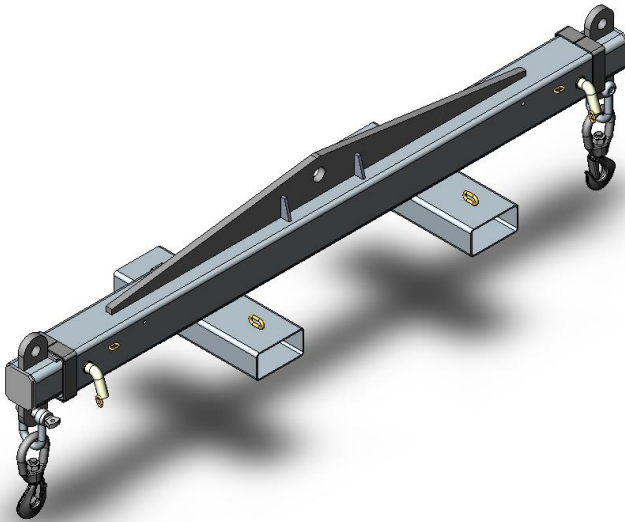

The type MCFM2439 Spreader Beam is a unique multi-tasking Beam which can be used by Crane or Forklift to lift long loads. Using a Crane, loads can be lifted via the centre single hook point (as a 'Lifting Beam'), or end lifted using a 2 leg Chain Sling (as a 'Spreader Beam'). If lifting by forklift, the 600mm long slipper pockets allow for fast and safe connection to the truck.

The Spreader Beam load connection points are adjustable to 3 positions by moving the extendable arms each end. Both extendable arms are locked into position via safety pins. The unit is supplied standard with a safety swivel hook each end.

The extendable arms are zinc plated with the main body painted in 'safety orange'.

The unit is fully 'Third Party' certified to the relevant Australian Standards – Certification Certificate supplied upon request.

SPECIFICATIONS:

- Rated Capacity (RC Max.): 10,000kg
- Load Centre (LC): 3900mm
- Unit Weight: 260kg
- F/Lift HCG: 300mm

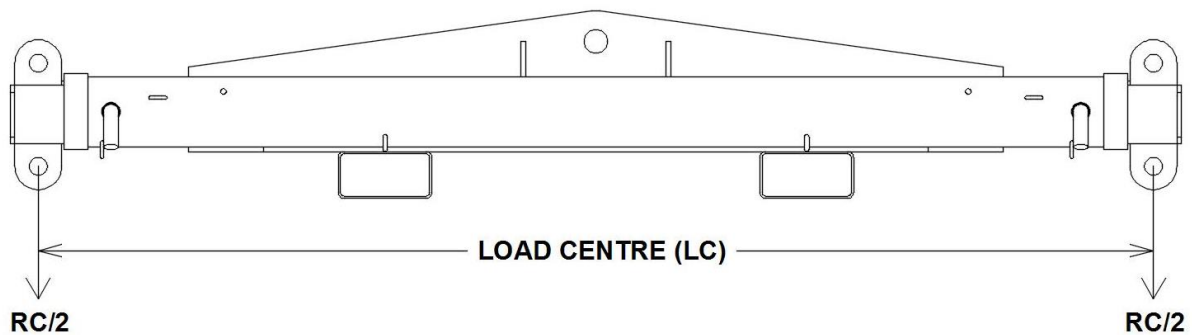

MCFM2439 LOAD CHART

RATED CAPACITY (RC) WHEN USED AS	FULLY RETRACTED (LC @ 2380mm)	MIDDLE POSITION (LC @ 3140mm)	FULLY EXTENDED (LC @ 3900mm)
FORKLIFT ATTACHMENT	5600KG	2900KG	1400KG
LIFTING BEAM	6000KG	4500KG	2400KG
SPREADER BEAM	10,000KG	10,000KG	10,000KG