

# LOG GRAB ATTACHMENT MGA01 SPECIFICATIONS

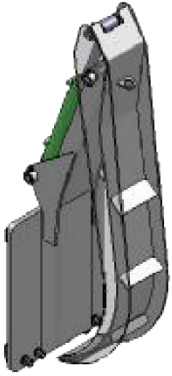

The **MGA01 Log Grab Attachment** is designed to securely hold logs in place for transport by a forklift, tractor or loader around the worksite.

## FEATURES:

- Allows the operator to safely transport timber posts, logs, stumps or fallen branches
- Hydraulic top claw secures the load being carried on the forks
- Suits Class 2A mount
- One additional hydraulic circuit required
- White enamel paint finish

## SPECIFICATIONS:

Unit Weight: 126 kg  
Opening Height: 1350 mm  
Lost Load: 56 mm  
HCG: 126 mm  
VCG: 920 mm

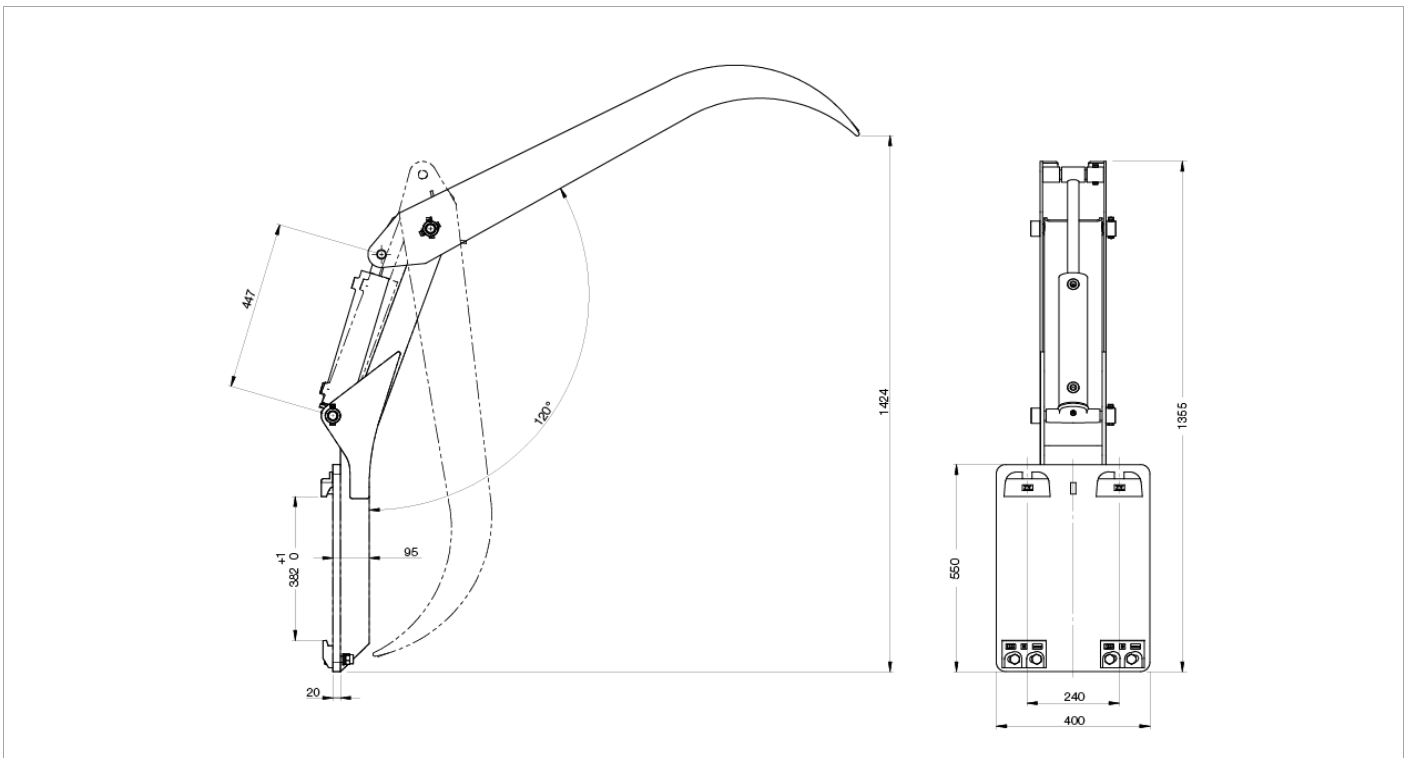

**NOTE:** Carriage, fork arms and bale spears are not included. Shown for illustrative purposes only

Australia Wide Sales & Service

sales@materialshandling.com.au | www.materialshandling.com.au | 1300 65 00 35

**MATERIALS**  
**Handling** *Working with ease*  
PTV LTD