

CRANE DRUM ROTATOR DCDR1000C SPECIFICATIONS

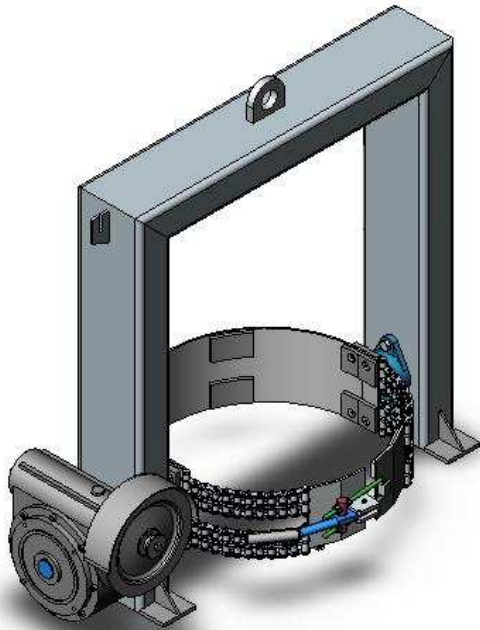

The type DCDR1000C Crane Drum Rotator is a heavy lift capacity Crane Drum Rotator suitable for mining operations, manufacturers and foundries. The Drum is quickly clamped into the holder via the twin Chain Belly Strap allowing 360° rotation.

This Unit is also available with a Handle driven gearbox for rotation – type DCDR1000H.

SPECIFICATIONS:

- Safe Working Load (SWL) 1000 kg
- Unit Weight 220 kg
- 360° Rotation
- Rotation Centre to Lifting Eye 940 mm

(shown without supplied Hand Chain)

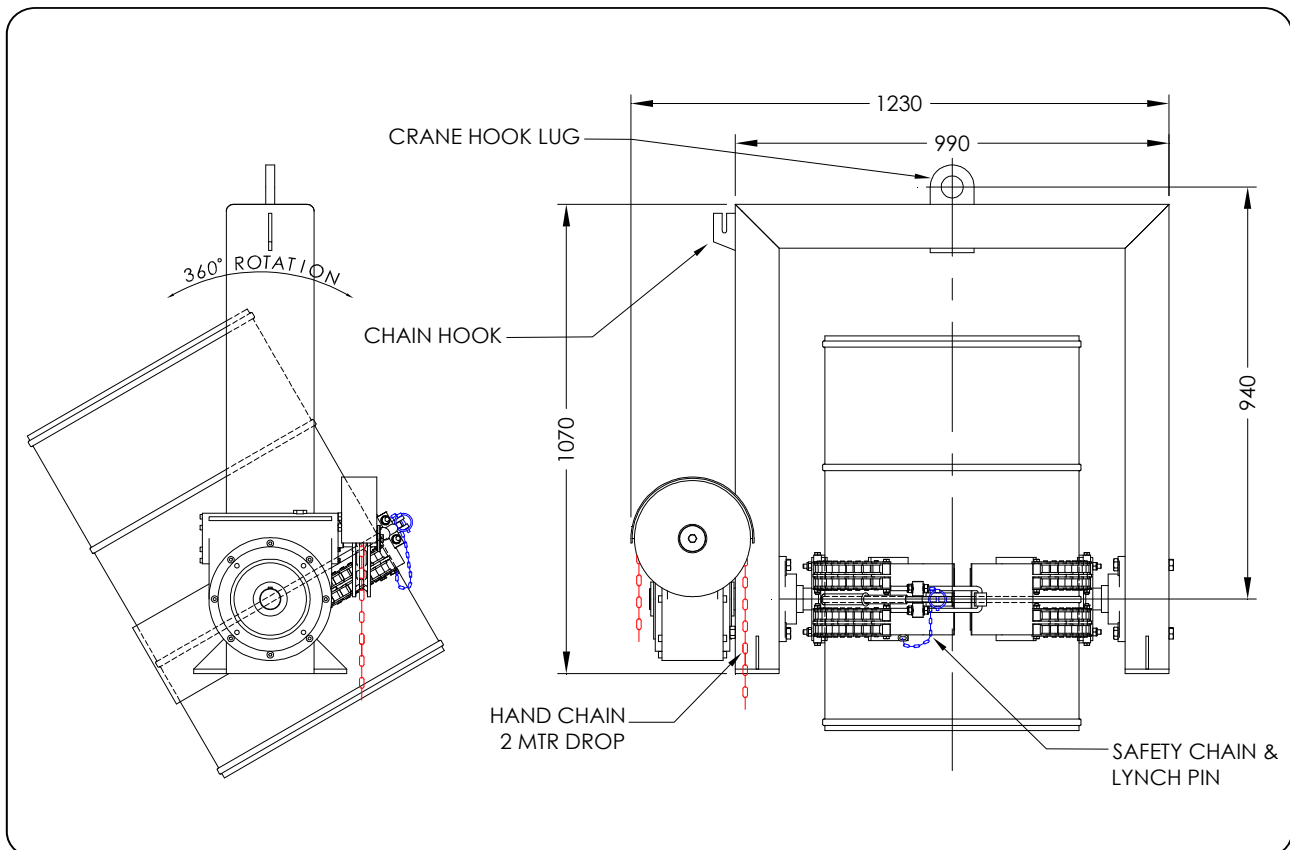

Australia Wide Sales & Service

sales@materialshandling.com.au | www.materialshandling.com.au | 1300 65 00 35

MATERIALS
Handling PTY LTD *Working with ease*