



# MTA100L

## Battery Electric Tug

- Lithium battery, convenient charging
- Compact design
- Large traction
- Comfortable and stable operation

**LI-ION**  
TECHNOLOGY

## FEATURES

### ■ Lithium battery: opportunity charging

Designed around the concept of Lithium Ion battery technology and equipped with Li-Ion battery as standard. Both on-board and external battery charger is available, which makes charging convenient depending on your application.



### ■ Remote control (optional)

The application of infrared remote control can easily control the tractor to move forward and backward within a certain range.



### ■ Large traction

Capable of towing 1000 kg cargo on a slope with the falling gradient of 3°.



### ■ Comfortable and stable operation

Fitted with 250mm diameter pneumatic tyres that generate good traction. The height of the control handle can be adjusted to suit each operation and particular user comfort.



# Battery Electric Tug

## MTA100L

Distinguishing mark	1.1	Type			Battery Electric Tug
	1.2	Model designation			MTA100L
	1.3	Drive			Electric
	1.4	Operator type			Pedestrian
	1.5	Load capacity	Q	kg	1000
Service weight	1.9	Wheelbase	y	mm	320
	2.1	Service weight		kg	120
	2.2	Axle loading, laden front/rear		kg	120/0
Tyres/chassis	2.3	Axle loading, unladen front/rear		kg	95/25
	3.1	Tyre type			Pneumatic
	3.2	Tyre size, front		mm	2x $\Phi$ 250x85
	3.3	Tyre size, rear		mm	2x $\Phi$ 75x32
	3.4	Additional wheels (castor wheels)		mm	—
	3.5	Wheels, number front/rear (x=drive wheels)		mm	2x /2
	3.6	Tread width, front	b10	mm	428
Dimensions	3.7	Tread width, rear	b11	mm	217
	4.2.1	Overall height	h15	mm	896~985~1074
	4.8	Seat height/standing height	h7	mm	—
	4.9	Height of tiller handle in drive position min./max.	h14	mm	841~936~1016
	4.12	Tow coupling height	h10	mm	—
	4.19	Overall length	L1	mm	1210~1270~1300
	4.21	Overall width	b1/b2	mm	520
Performance data	4.32	Ground clearance, center of wheelbase	m2	mm	—
	5.1	Travel speed, laden/unladen		km/h	4.5/5
	5.5	Drawbar pull, laden/unladen		N	200/0
	5.6	Max. drawbar pull, laden/unladen		N	650/0
	5.8	Max. gradeability, laden/unladen		%	3/16
Electric-engine	5.10	Service brake			Electromagnetic
	6.1	Drive motor rating S2 60 min		kW	0.4
	6.4	Battery voltage/nominal capacity		V/Ah	24/20
	6.5	Battery weight		kg	5.8
Addition data	8.1	Type of drive control			DC
	10.5	Steering design			Mechanical
	10.7	Sound pressure level at the driver's ear		dB(A)	74
	10.8	Towing coupling, type DIN 15170			—

If there are improvements of technical parameters or configurations, no further notice will be given.  
The diagram shown may contain non-standard configurations.

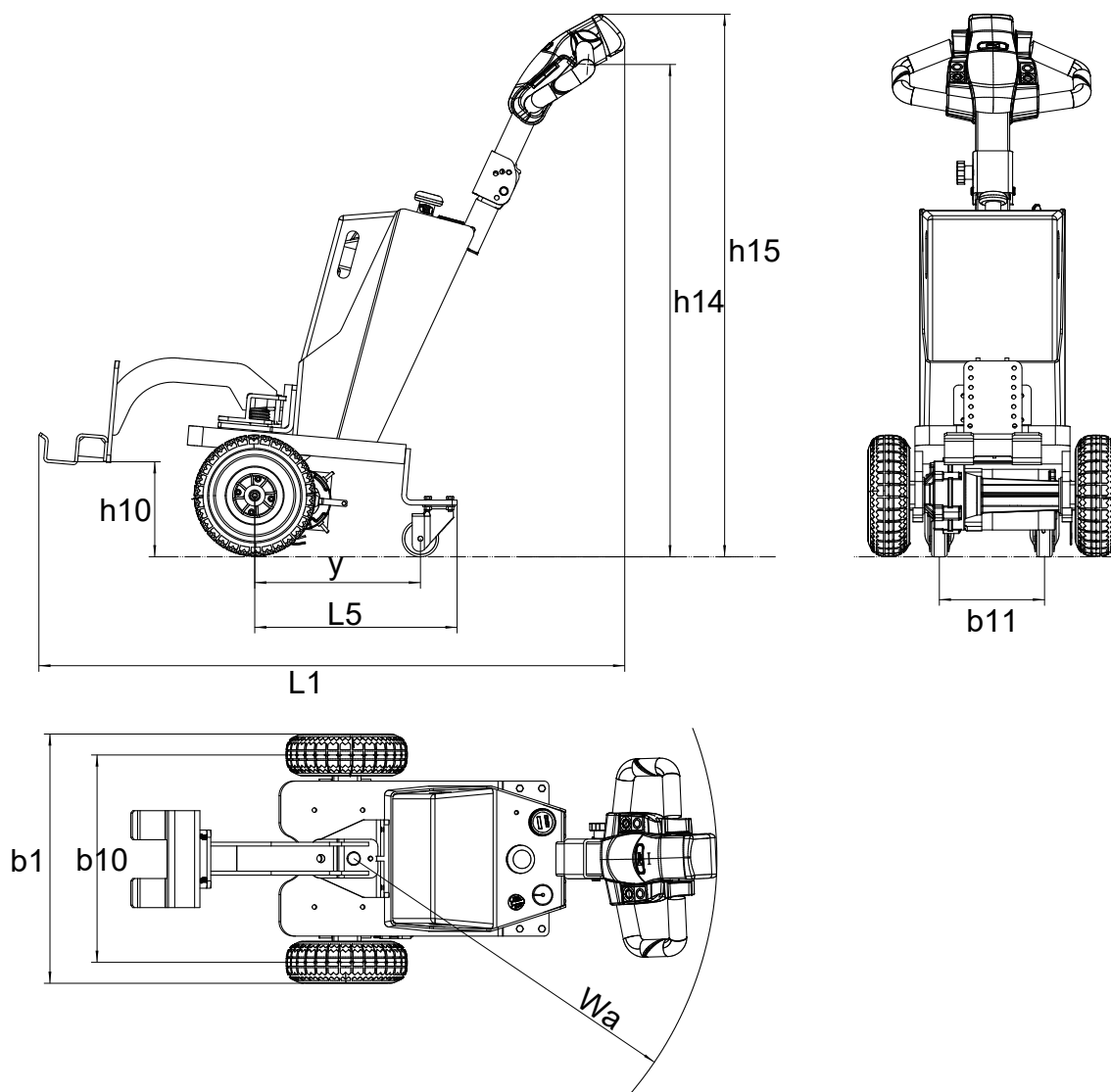

## Option:

No.	Optional items	
2.3	Drive wheel material	○Rubber
2.5	Front wheel material	●Pneumatic
2.8	Charger	●24V-10A External
2.9	Battery indicator	●With time
2.13	Traction pin	●Yes○Yes and not customized
Note: ●Standard ○Optional - Inconformity		

Australia Wide Sales & Service

sales@materialshandling.com.au | www.materialshandling.com.au | 1300 25 84 07

**MATERIALS**  
**Handling** PTY LTD *Working with ease.*