

# FLOOR MOUNTED DRUM TIPPER FMDT1 SPECIFICATIONS

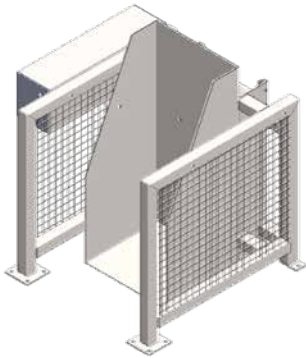

The FMDT1 Floor Mounted Drum Tipper is designed to allow safe and effortless tipping of drums.

## Features:

- Allows for 130 degree rotation of a standard 205L drum
- Operated by hydraulic lever
- Supplied with side safety barriers
- Hydraulic power pack, 240-volt, 2.2kw
- Tipping height approx. 1m above floor
- 20 second full tipping cycle
- Cradle flush to ground for ease of leading
- Stainless steel cradle available on request
- Can be customised to suit application or drum type on request
- Zinc-plated finish



Working Load Limit (WLL)	600kg
Rotation	130°
Overall Dimensions	1360 x 1255 x 1400mm
Unit Weight	350kg
Fork Pocket Size	185 x 60mm
Fork Pocket Centres	350mm

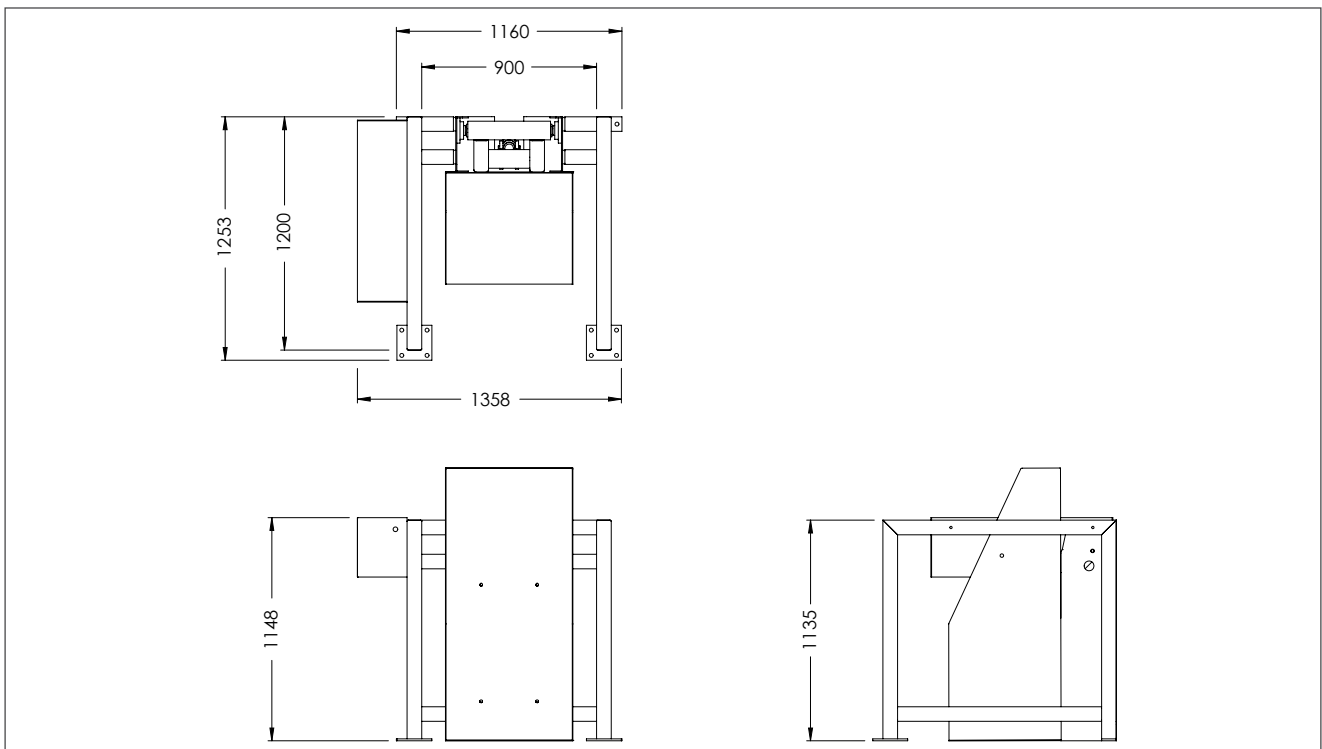

Australia Wide Sales & Service

sales@materialshandling.com.au | www.materialshandling.com.au | 1300 25 84 07

**MATERIALS**  
**Handling** PTY LTD Working with ease.