

CargoMaster BCC200

The newest generation of stair climber

The CC series is the newest development of stairclimbers. Due to the numerous technical novelties such as the **ComfortStep** or the multi-level battery display, the CC series sets new standards concerning handling and ease of use.

Because of the patented and standard **ComfortStep** even sensitive loads can be transported. The **ComfortStep** convinces by quietly and softly touching down on the step making it an indispensable aid for the transportation of even highly sensitive loads.

The integrated battery display informs you at all times on the actual charging capacity and offers the user maximum safety.

Due to the well-tryed brake, which stops automatically at the edge of a step, the CC series becomes your reliable partner for any type of transportation problem.



Advantages that convince

- Safe transportation of loads up to 200 kg
- **ComfortStep** for easy and gentle climbing
- Integrated, multi-levelled battery display



200kg

TRH1
EG

Industrie
S. 7, 8



Safe and with little physical effort —

The CargoMaster is not only powerful, but also quick

Because of its lean design yet sturdy construction, the CC series lends itself particularly well to be used in manufacturing, trade, and business.

You can easily transport bulky goods such as grinding machines, linoleum spools, or wood-burning stoves up to 200 kg.

Even on narrow stairs you can rely on the CargoMaster. Its safe climbing mechanism conquers even spiral staircases, plus it can be used on virtually any surface. The edges of steps are not damaged. The CargoMaster is very versatile and can handle optimally the most diverse situations of transportation. One battery charge lasts up to 30 levels.

The CargoMaster's climbing speed can be adjusted continuously. The safety brakes stop automatically at each step's edge. Adjustments on the stairs are thus possible at all times. Thanks to the standard single step mode even very narrow staircases can be climbed safely.

Due to its low empty weight, the CargoMaster can be taken anywhere without problem. You can store it tightly in your car by inserting the grips and folding up the blade.



Battery display, single step control and ComfortStep



Continuously adjustable climbing speed

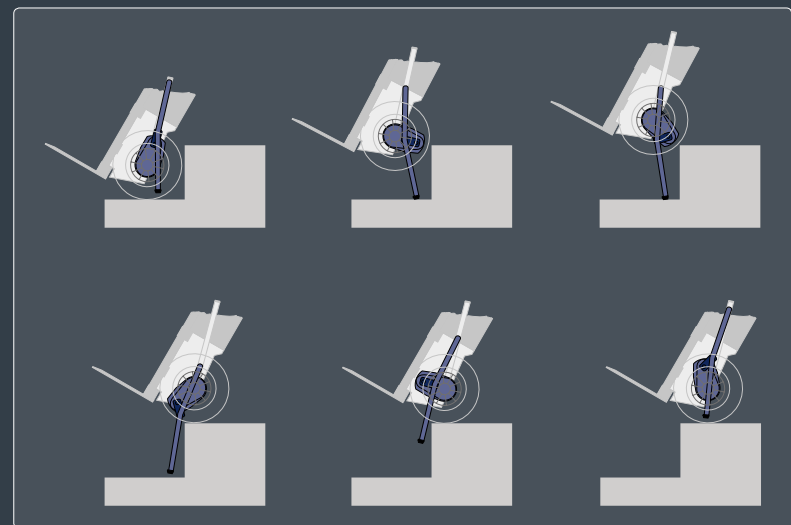

The reliable climbing mechanism safely manages each step

CargoMaster BCC200 —

That's the way you transport things today

Either as a stair climber or a push cart, the CargoMaster is a transportation aid on stairs as well as on level ground.

The powerful electric drive is fed by a battery, which can be charged with a power supply?

The tires made of solid rubber are puncture-proof—also under long-term stress of the wheels. The driving comfort is comparable to that of pneumatic tires. As an option, various pneumatic tires are available.

Its low empty weight and easy handling make the CargoMaster an indispensable aid.

Inside or outside — the CargoMaster is a strong partner in any type of environment.

The CC series of the CargoMaster includes the **BCC160** with a lifting power of 160 kg, and the **BCC200**, which is capable of lifting up to 200 kg.

For special challenges, there is a great variety of accessories to equip your CargoMaster optimally for individual tasks of transportation.





CargoMaster BCC160

Versatile and cost-saving —

The CargoMaster
increases your efficiency





160kg



The CargoMaster BCC160 —

An all-rounder because of intelligent accessories

Due to a great variety of accessories, the CargoMaster can be adjusted to the respective, individual problem of transportation.

With completely inserted grips the CargoMaster BCC160 only has a pack size of 1065 x 466 x 290 mm. Thus, it can be stored without problem in smaller transportation vehicles or even in your private car.

In addition to all the advantages of the CC-series, the grips can also be adjusted in height and inclination. Thus, this flexible device can be adjusted to the user's height, and the respective load's center of gravity can also be adjusted.



Standard equipment

The delivery package includes a stair climber (BCC160 or BCC200), plus a battery pack with locking device, puncture-proof tires, a standard blade, charger, and lashing strap.



Intelligent accessories —

For all situations of transportation



Front plate

Made of safety plexiglass to protect the goods from sliding through or from scratching.



Back wall

Made of aluminum with a felt cover to protect the goods from sliding through and from scratching.



Pneumatic tires

black



Pneumatic tires

grey

Item number	BCC160		BCC200	
Back wall	100674			
Support for white goods	100673			
Lock for plate	100611			
Front plate	100612	100614		
Battery pack	100610			
Charger	100027			
Charging cable for the car	12 V	100022		
	24 V	100024		
Pneumatic tires	black (extra charge)	100462		
	grey (extra charge)	100519		
Support for round containers	100012			
Extended climbing height	0,5 cm	100670		
	1,5 cm	100671		
Extended grips + 20 cm (extra charge)	100616			
Auxiliary stairs	steps	3 steps	4 steps	5 steps
	regular support	100017	100018	100126
	extended support	100325	100326	100522
Auxiliary stairs for extra heavy loads	extended support	104089	104004	104118



Auxiliary stairs made of steel, takes a load of up to 350 kg or for particularly heavy loads, up to 500 kg

Thanks to these stairs you can comfortably load and unload your transporter, trailer, or transportation vehicle. Boot sills between 480mm – 900mm in height are possible. If your vehicle has a tow-bar you need the auxiliary stairs with an extended support.



Support for round containers

With a diameter of approximately 150 – 800 mm to protect round goods. Easy assembly by popping it on.



Support for white goods



Charger

Additional charger.



Charging cable for the car

Available in 12 V or 24 V.



Battery pack

Additional battery pack for continuous operation.



Lock of the toe plate



Extended grips

20 cm longer than standard grips.

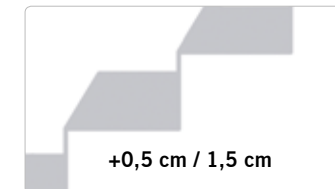

Extended climbing height

Extension by 0.5cm / 1.5cm.

Toe plate variety

CargoMaster BCC160/BCC200

Choose the appropriate toe plate for your personal transportation situation from the variety we offer.

We are happy to create and produce special plates for your particular demands.

Item number		BCC160	BCC200
Standard toe plate 310 x 250 x 230 mm	included in the delivery package		-
	additional		100608
Toe plate 440 x 241 mm	instead of standard version (extra charge)		100662
	additional		100663
Toe plate 600 x 120 mm	instead of standard version (extra charge)		100664
	additional		100665
Toe plate 400 x 440 mm	instead of standard version (extra charge)		100666
	additional		100667
Toe plate to hook on 430 x 405 mm			100668
Toe plate for a laundry cart			100669

Standard toe plate
310 x 250 x 230 mm

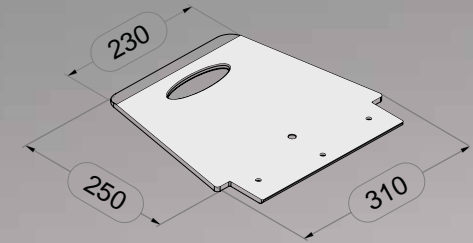

Toe plate
440 x 241 mm

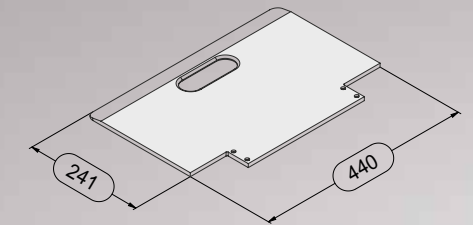

Toe plate
400 x 440 mm

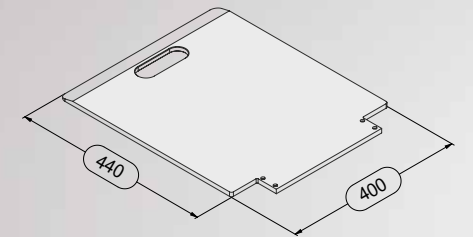

Toe plate to hook on
430 x 405 mm

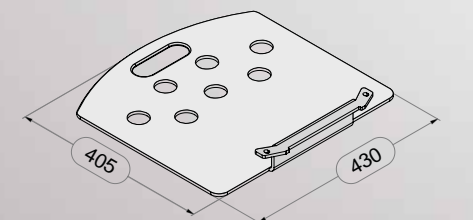



Toe plate
600 x 120 mm

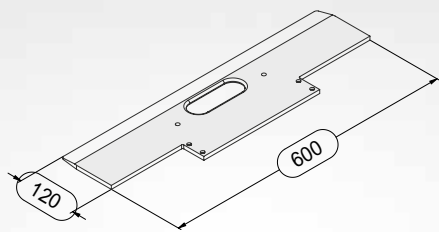

Toe plate for a laundry cart
295 x 241 x 101 mm

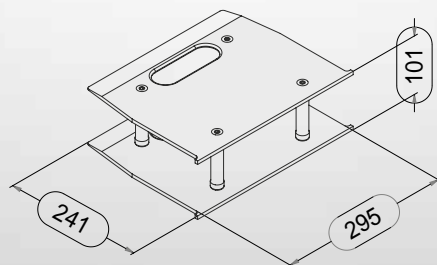

Technical data	BA142	BA350	BC141	BC141 Vario	BCC160	BCC200	BC400	Vario-max
Lifting capacity	140 kg	350 kg	140 kg	140 kg	160 kg	200 kg	400 kg	170 kg / 160 kg *
ComfortStep	-	-	-	-	•	•	-	-
Battery display	-	-	-	-	•	•	-	-
Climbing speed / steps per minute (continually adjustable)	8 — 25	4 — 10	8 — 30	8 — 30	9 — 26	4 — 19	3 — 8	8 — 23
Range with one charge of the battery (Floors, depending on load)	30 — 50 Corresponds to: 80 kg approx. 1110 Steps 140 kg approx. 720 Steps	15 — 30 Corresponds to: 200 kg approx. 650 Steps 250 kg approx. 540 Steps 350 kg approx. 330 Steps	15 — 30	15 — 30	15 — 30	15 — 30	8 — 15	10 — 25
Height	1100 - 1700 mm	1195 - 1785 mm	1380 mm	1060 — 1400 mm	1065 — 1490 mm	1065 — 1490 mm	1512 mm	1060 — 1400 mm
Width	580 mm	590 mm	450 mm		466 mm	466 mm	564 mm	450 mm
Depth	470 mm	520 mm	300 mm		290 mm		782 mm	550 mm
Batteries	2 x 12 V / 7,2 Ah		2 x 12 V / 5 Ah					
DC motor	24 V							
Weight, battery pack	6 kg		4,1 kg					
Total weight (including battery pack)	32 kg	46 kg	25,5 kg	26,7 kg	28,5 kg	29,9 kg	84,3 kg	35 kg

*Maximum lifting capacity (passenger transportation)