

Product Specifications

Type MWCB Crane Bin

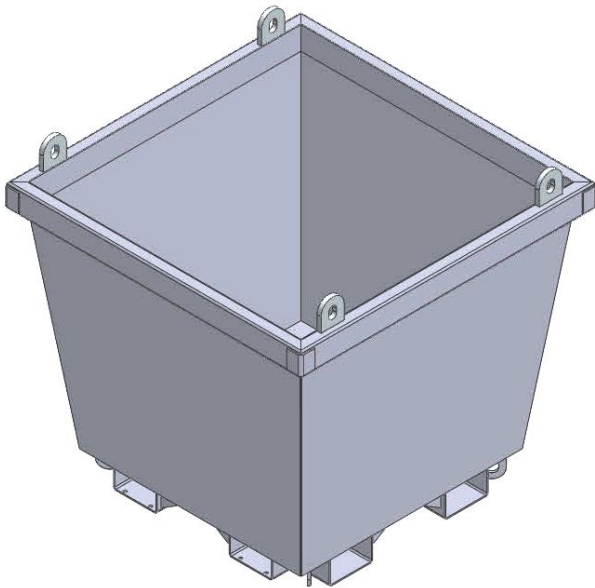

The type MWCB Crane Bin has been designed with space saving contours to allow the bins to interlock for transport and storage and is suitable for all waste products. All bins are fitted with 4-way entry fork pockets allowing emptying by rotating Forklift from all sides, or positive handling on uneven ground. Four Crane Lugs are fitted along with upending lugs for Crane emptying.

They can nest into each other, up to 5 deep, for transport.

All type Bins have a Working Load Limit of 2000kg manufactured from 3mm steel plate. Two sizes are available with 0.85 and 2.5 cubic metre capacities.

The standard finish on the Bins is Hot Dip Galvanised.

SPECIFICATIONS:

- Working Load Limit: 2000kg
- Unit Weight – refer Table
- Volume Capacity – refer Table
- Pocket Sizes: 160 x 95 & 160 x 75mm
- Pocket Centres - refer Table

OPTIONS:

- Wheels

